

© COPYRIGHT 2005 TEXAS INSTRUMENTS UNPUBLISHED. ALL RIGHTS RESERVED

REVISIONS			
REV	DESCRIPTION	DATE	UPDATED BY
A	INITIAL RELEASE	9/23/11	AA
B	ADDED FOUR 4-40 HOLES FOR SENSOR MOUNT	10/18/12	AA

- NOTES: UNLESS OTHERWISE SPECIFIED:
- THIS IS A PURCHASE PART DRAWING FOR 2511989 TEST SOCKET ASSEMBLY FOR M-MAX .7 PACKAGE. NO MODIFICATIONS OR CHANGES ARE TO BE MADE.
  - SUPPLIER IS TO MARK PART '2511989 [x]'. [x] REPRESENTS CURRENT DRAWING REVISION. REVISION MARKING IS TO INCLUDE PARTIAL UPDATES. EG. [A1], [B1].
  - THIS DRAWING SHOWS ESSENTIAL FEATURES TO INTERFACE SOCKET TO M-MASTER SYSTEM; AND SHALL BE USED AS REFERENCE ONLY. DETAILED DRAWING SHALL BE PRODUCED AND MAINTAINED BY SUPPLIER.
  - TOLERANCES: .XXXX = ± .0010 OR AS NOTED.

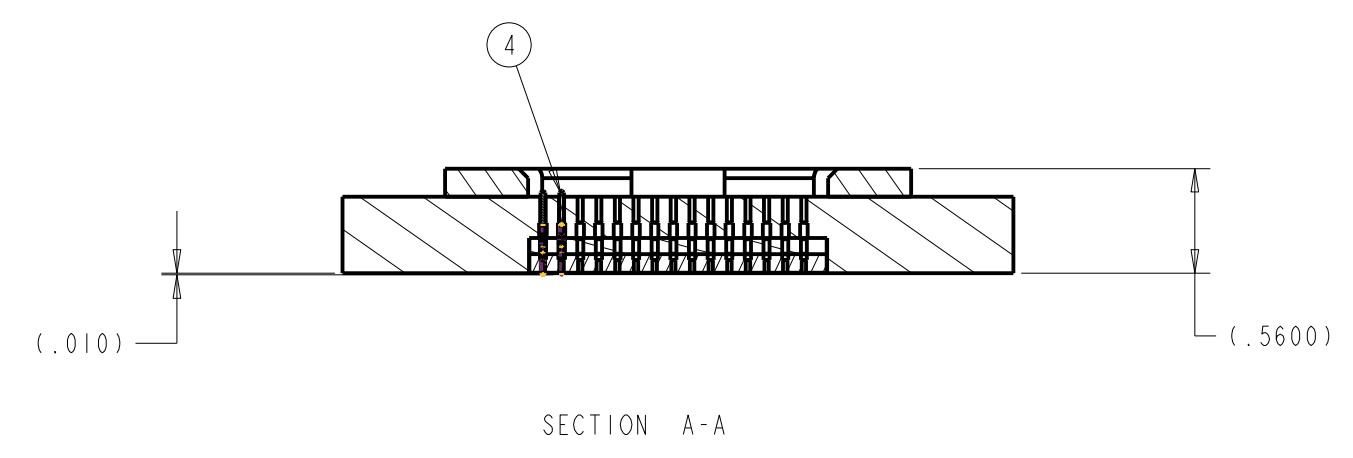
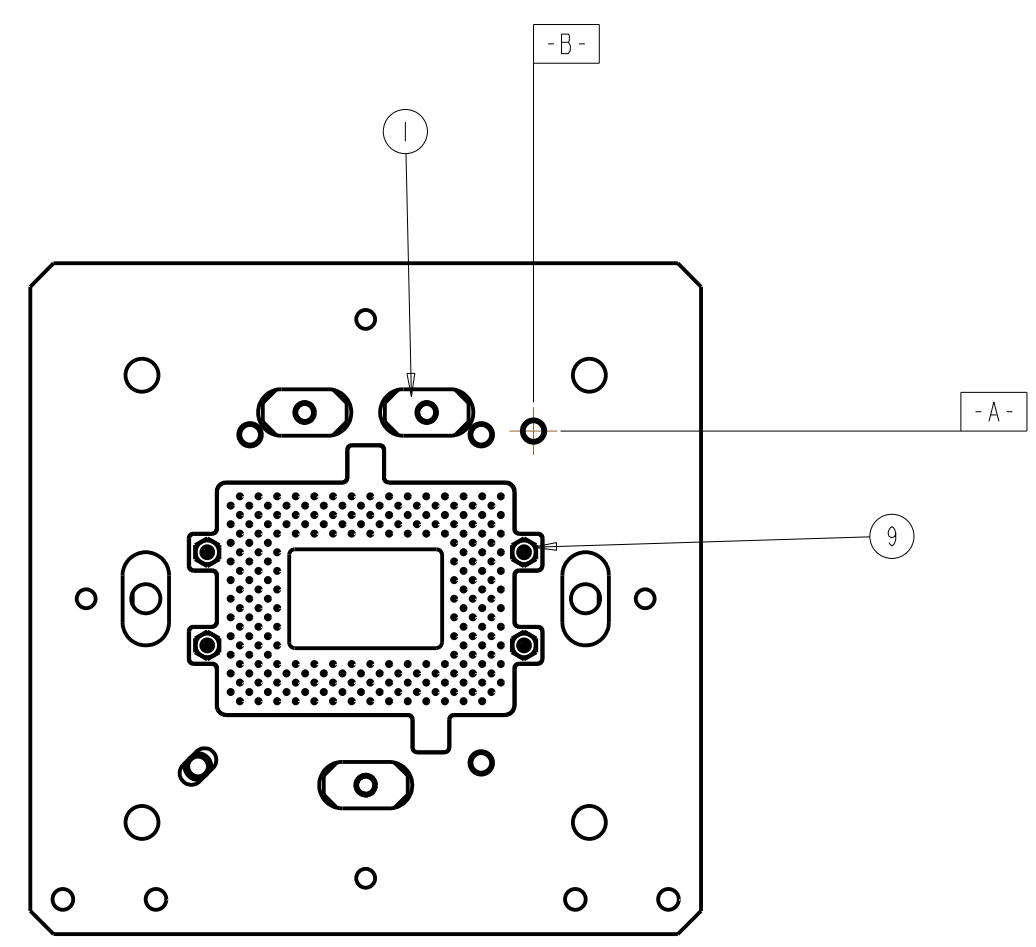
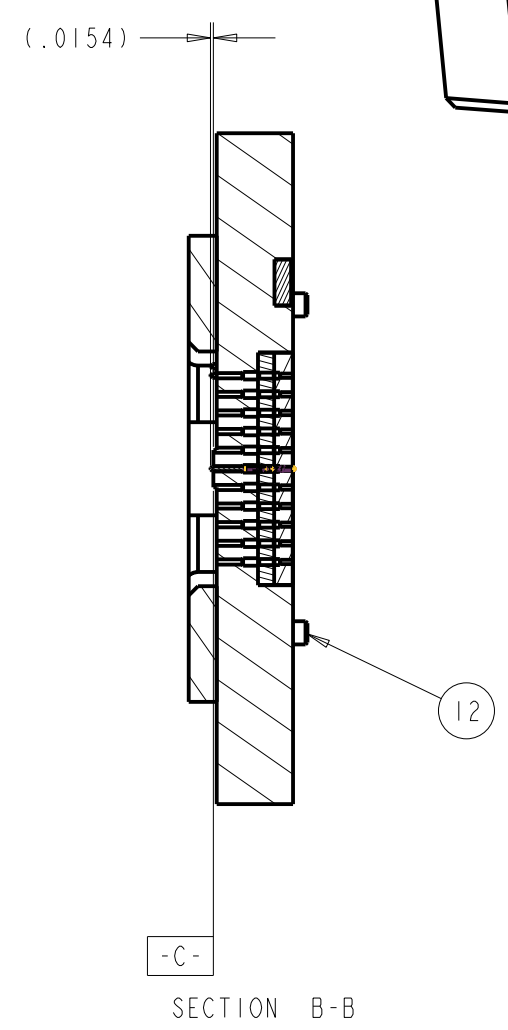
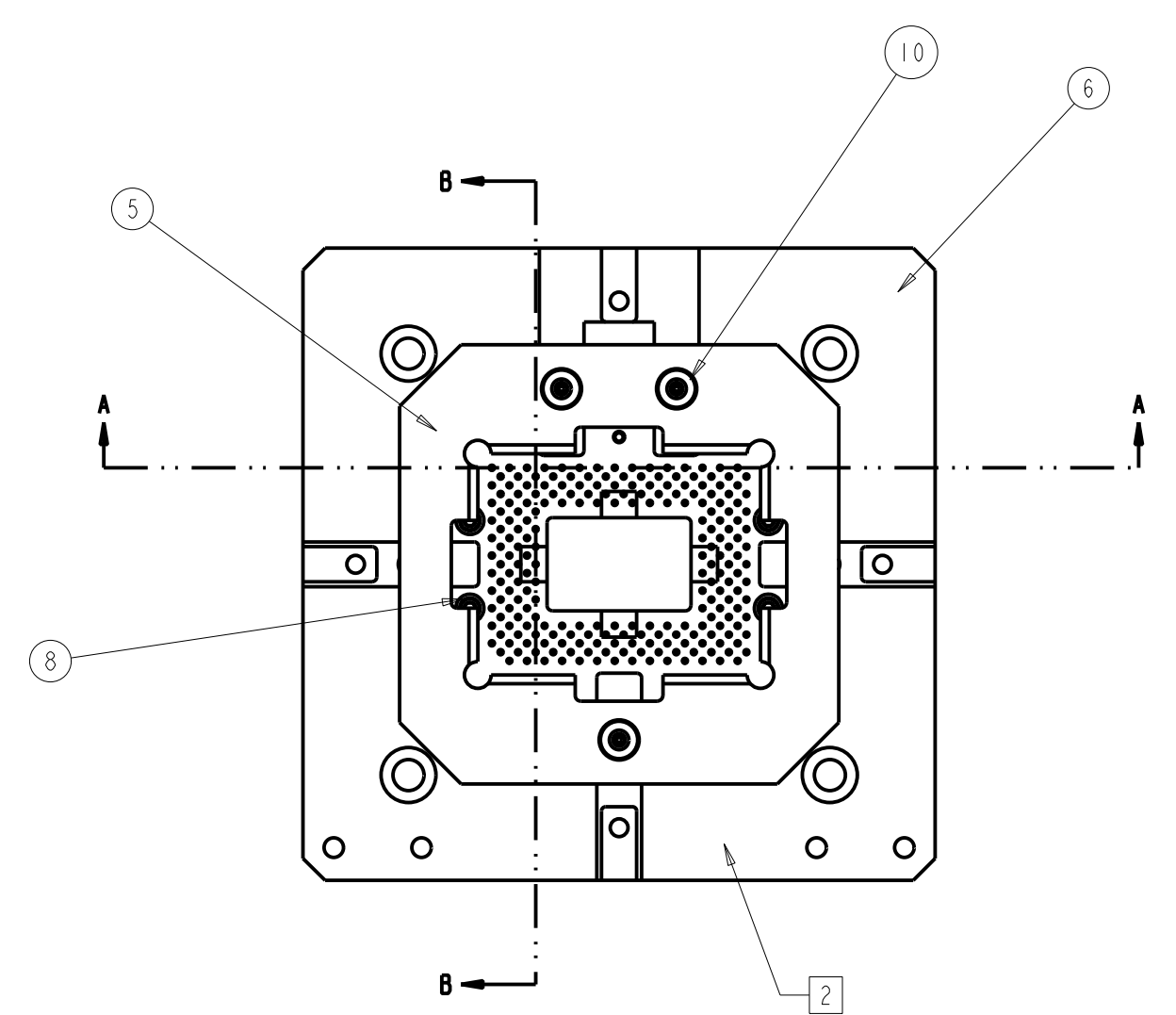
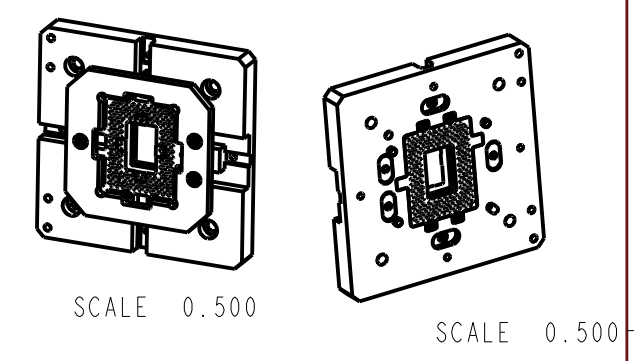
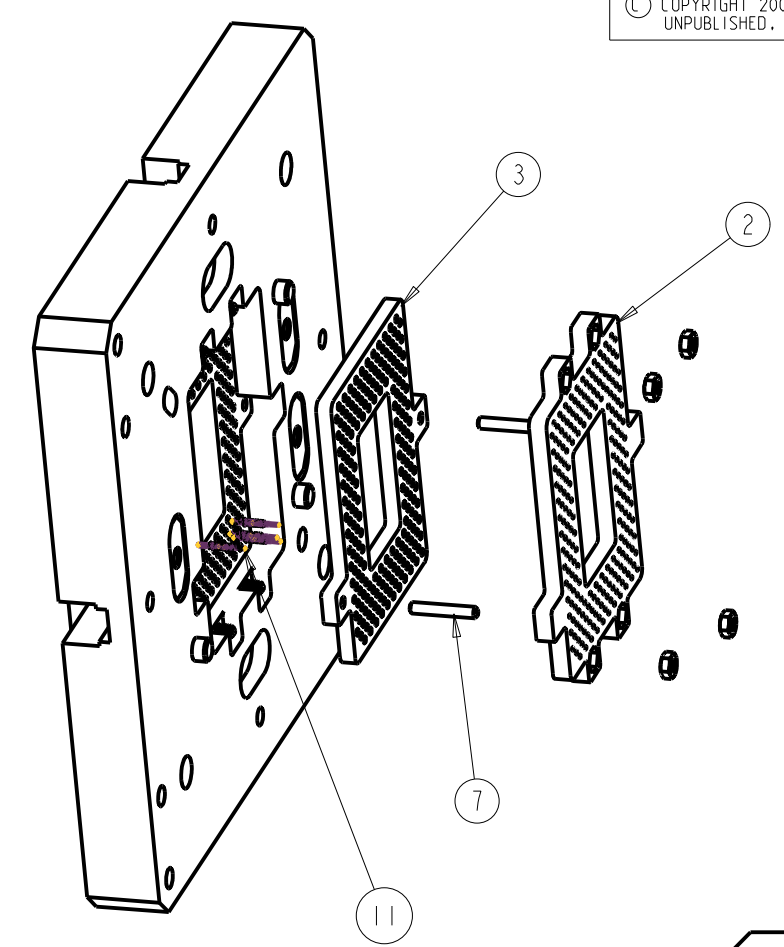

QTY	ITEM NO	PART OR IDENTIFYING NUMBER	NOMENCLATURE OR DESCRIPTION	NOTES
3	12	90145A876	DOWEL PIN, 1/8 DIA X 3/16 [MCMaster-CARR]	
4	11	H077AA3A	H-PIN, PLASTRONICS (FOR REFERENCE ONLY)	
3	10	92949A111	SCREW, 4-40, 7/16" LG [MCMaster CARR]	
4	9	91828A006	NUT, M1.6 [MCMaster CARR]	
4	8	91290A023	SCREW, M1.6 X 6mm LG [MCMaster CARR]	
2	7	90145A417	DOWEL PIN, 1/16 DIA X 3/8 LG [MCMaster-CARR]	
1	6	2511988	TEST SOCKET BODY, M-MASTER/M-MAX, .7 TYPE A	
1	5	2511987	TEST SOCKET FUNNEL, M-MAX, .7 TYPE A	
4	4	2511978	TEST SOCKET EXTENDER, Type A	
1	3	2511977	POGO PIN RETAINER PLATE, .7 TYPE A	
1	2	2511976	TEST SOCKET RETAINER PLATE, .7 TYPE A	
3	1	2506983	NUT PLATE	

<p>UNLESS OTHERWISE SPECIFIED</p> <ul style="list-style-type: none"> <li>DIMENSIONS ARE IN INCHES</li> <li>TOLERANCES: ANGLES ± 1°</li> <li>3 PLACE DECIMALS: ± .010</li> <li>2 PLACE DECIMALS: ± .02</li> <li>DIMENSIONAL LIMITS APPLY BEFORE PROCESSES</li> <li>INTERPRET DIMENSIONS IN ACCORDANCE WITH ASME Y14.5M-1994</li> <li>REMOVE ALL BURRS AND SHARP EDGES</li> <li>PARENTHEetical INFO FOR REF ONLY</li> </ul>		<p>DWN A ALJASER DATE 23-Sep-11</p> <p>ENGR</p> <p>QA</p> <p>APVD</p>	<p>TEXAS INSTRUMENTS Dallas, Texas</p> <p>TEST SOCKET .7 PACKAGE, TYPE A M-MAX</p>
<p>314FT</p> <p>APPLICATION</p>	<p>SCALE 1.500</p> <p>SHEET 1 OF 7</p>	<p>SIZE DWG CLASS CODE DRAWING NO 2511989</p> <p>REV B</p>	

1. MACHINE RADI .062 MAX, UNLESS OTHERWISE STATED.
2. PART MUST BE COMPLETELY FREE OF MACHINING LUBRICANTS INCLUDING TAPPED HOLES.
3. DEBURR ALL EDGES.
4. MATERIAL: TORLON
5. TOLERANCES: .XXXX ± .0010 OR AS NOTED.

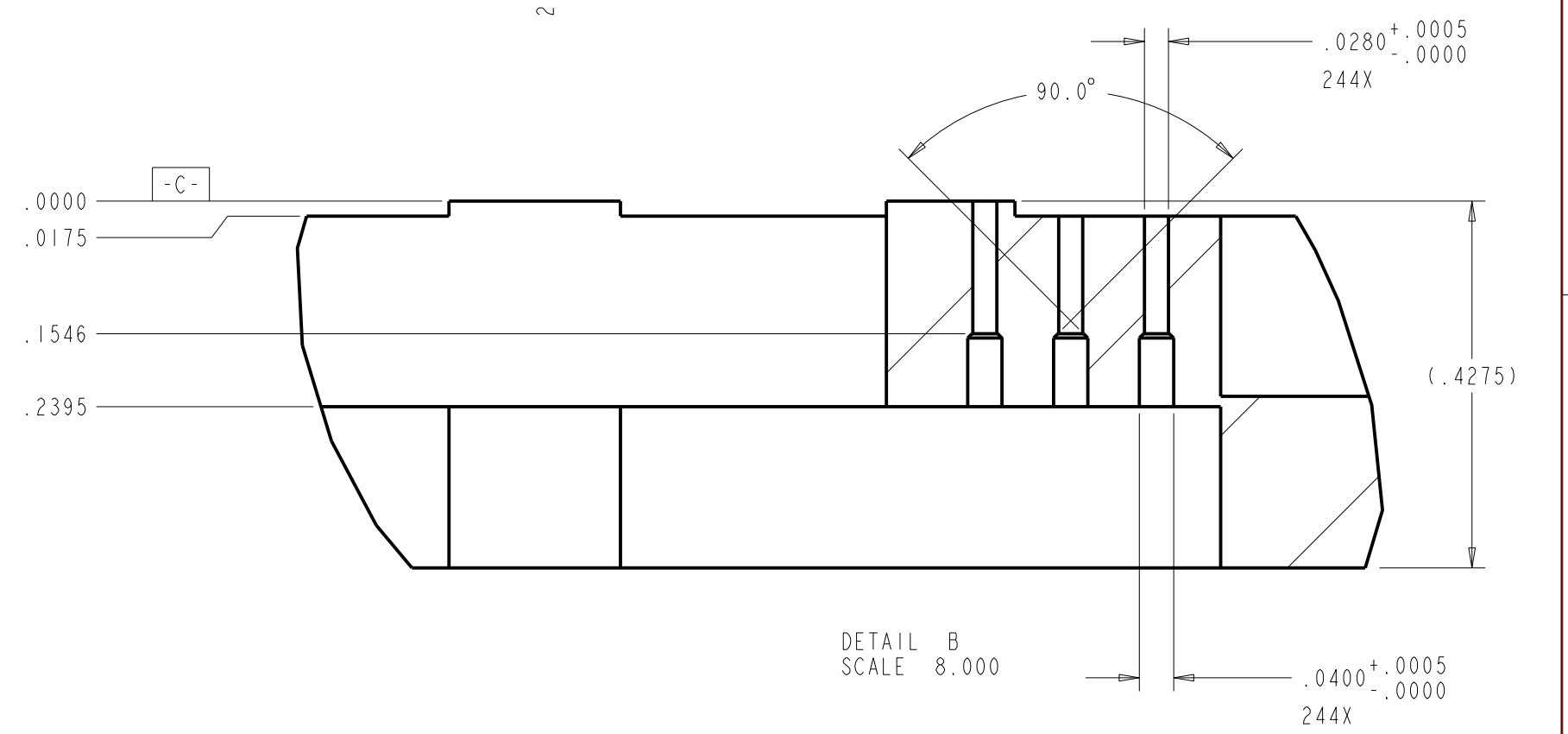
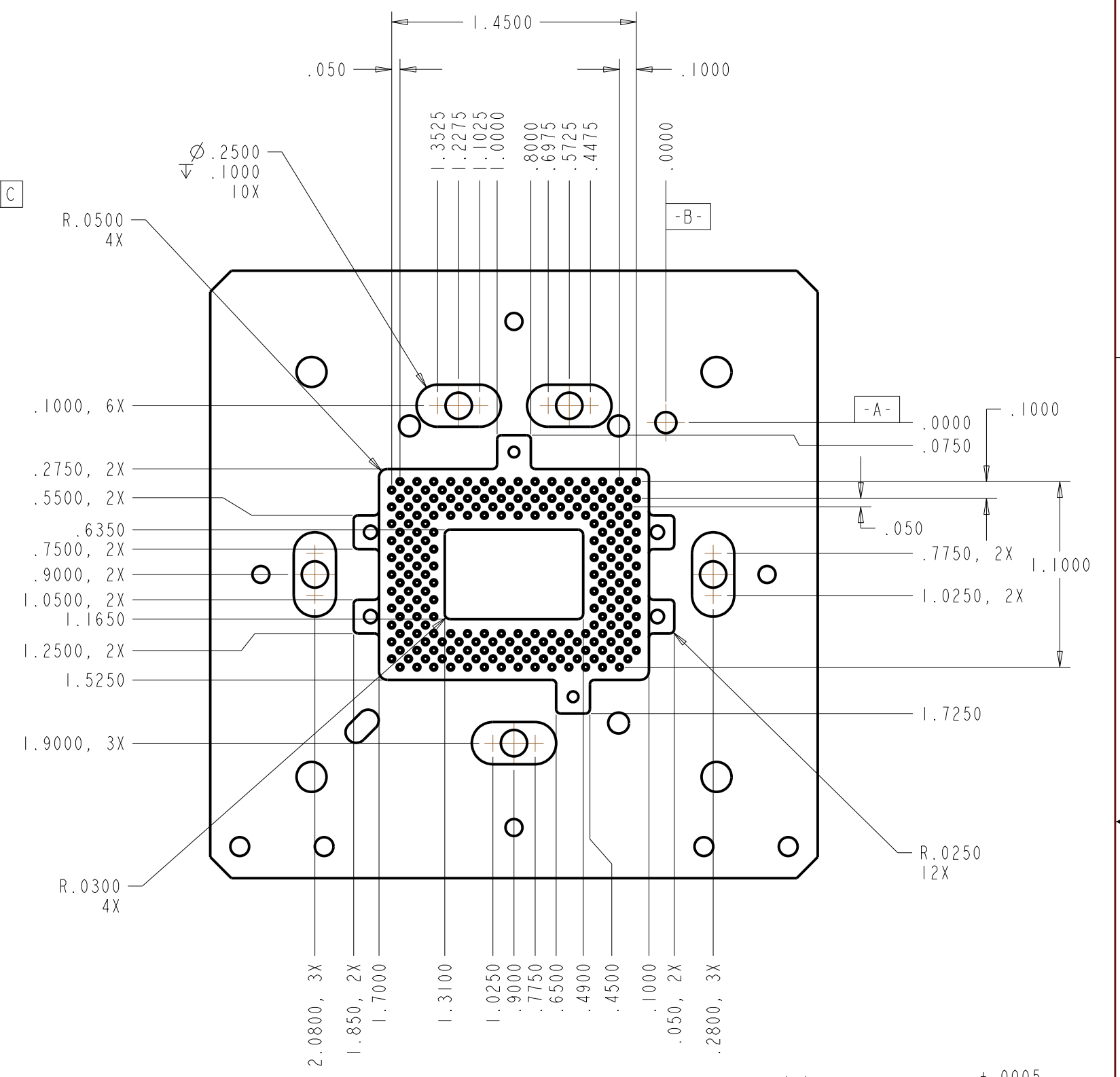
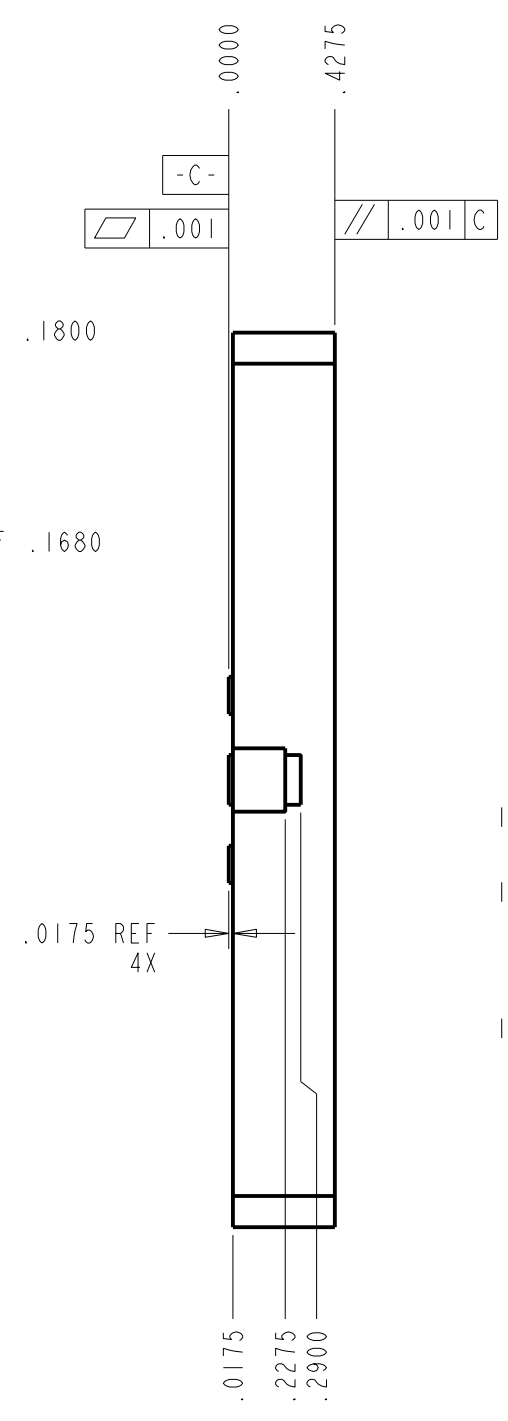
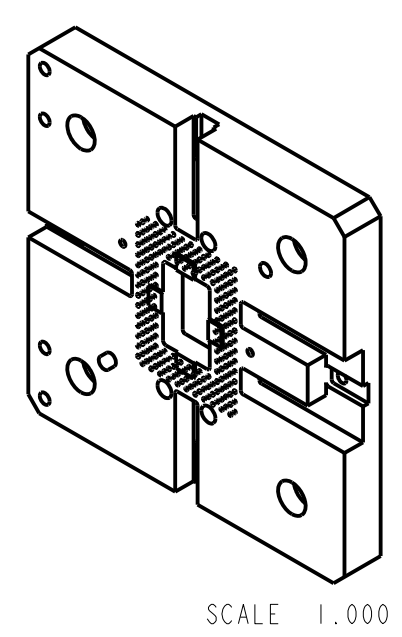
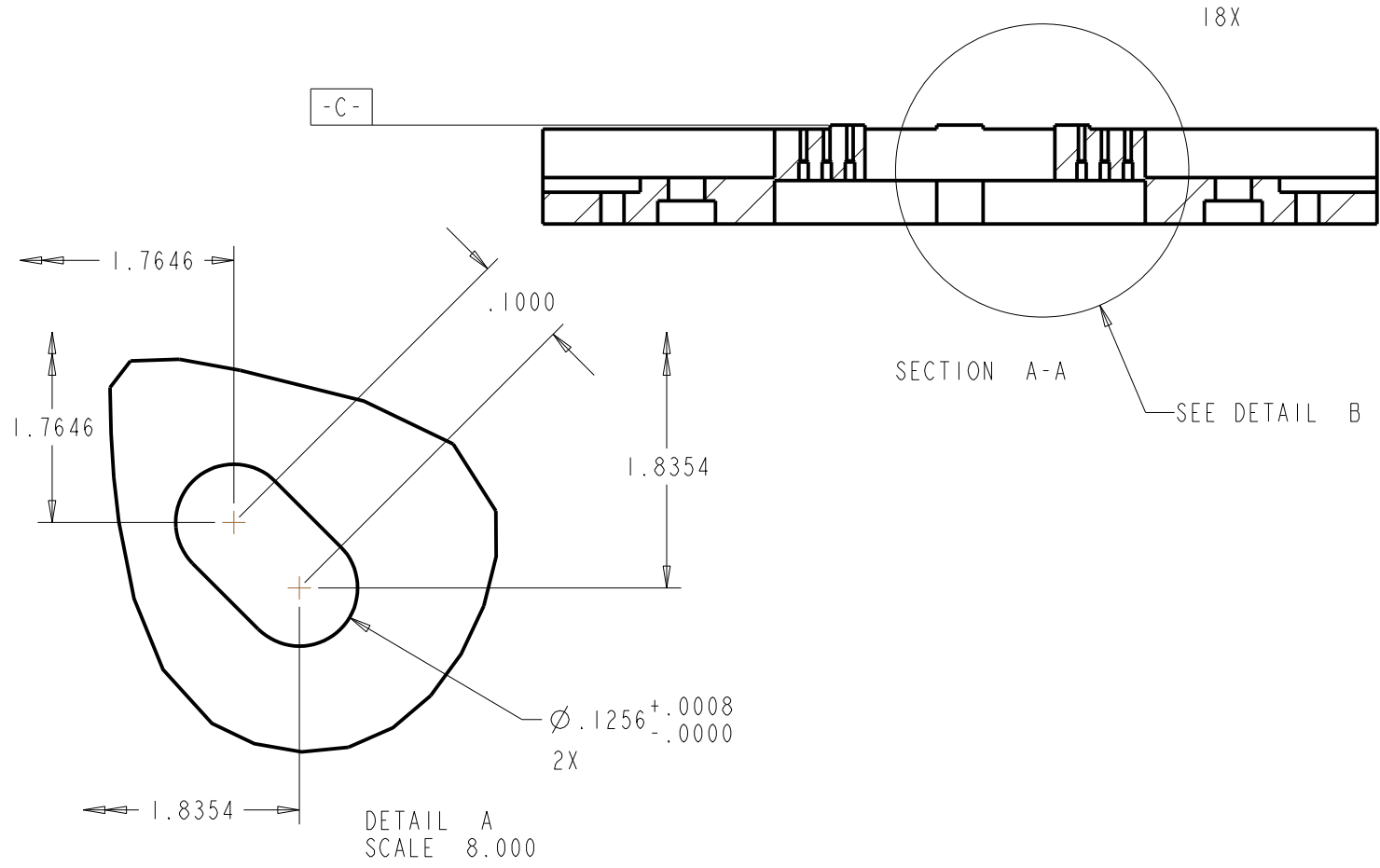
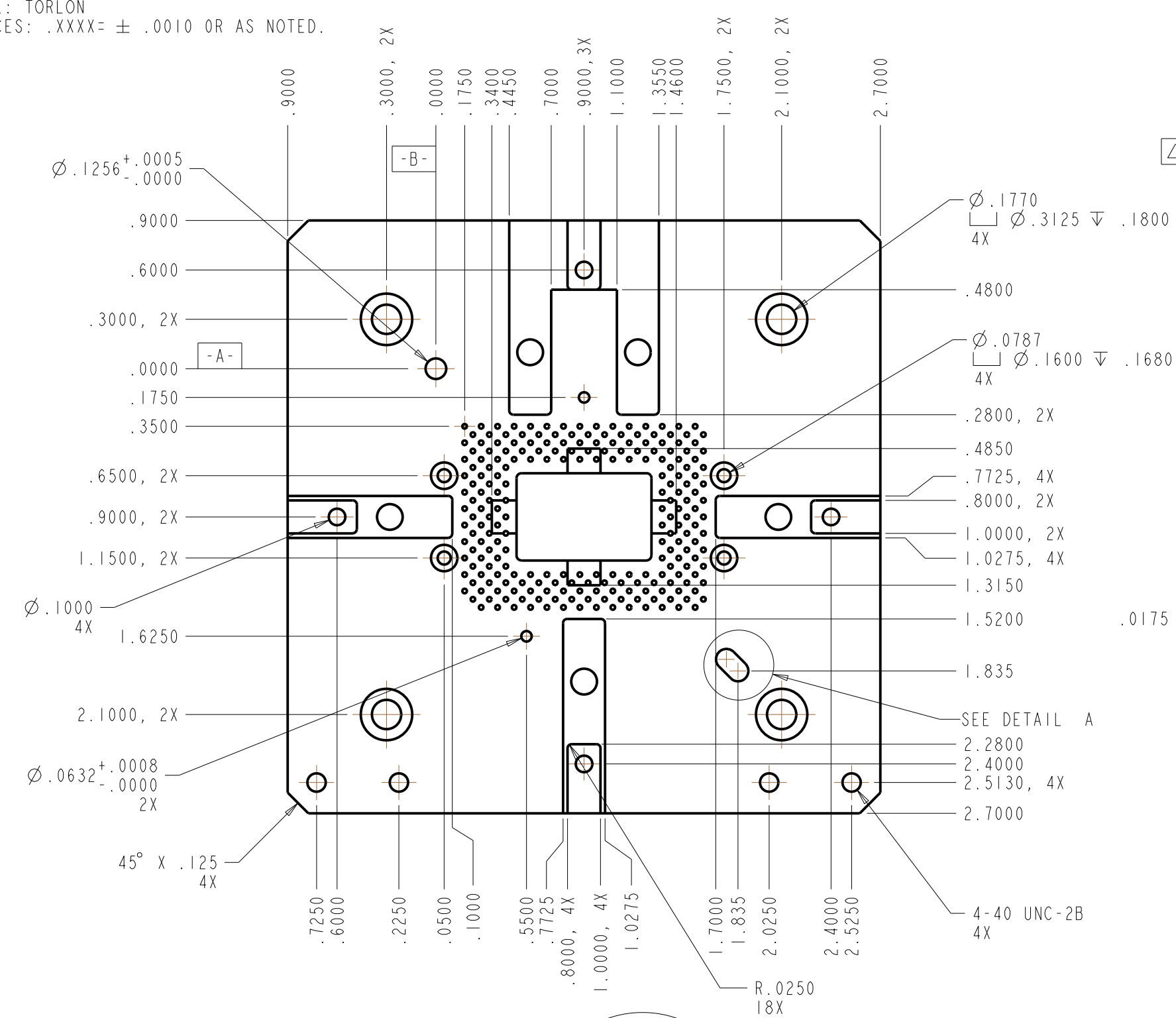

DETAIL B  
SCALE 8.000

 TEXAS INSTRUMENTS DALLAS, TEXAS	DWN A ALJASER	DATE 23-Sep-11	SIZE D	DRAWING NO 2511989	REV B
	ISSUE DATE		SCALE 1.500	SHEET 2 OF 7	

© COPYRIGHT 2005 TEXAS INSTRUMENTS  
ALL RIGHTS RESERVED

1. MACHINE RADII .062 MAX. UNLESS OTHERWISE STATED.
2. PART MUST BE COMPLETELY FREE OF MACHINING LUBRICANTS INCLUDING TAPPED HOLES.
3. DEBURR ALL EDGES.
4. MATERIAL: TORLON
5. TOLERANCES: .XXXX= ± .0010 OR AS NOTED.

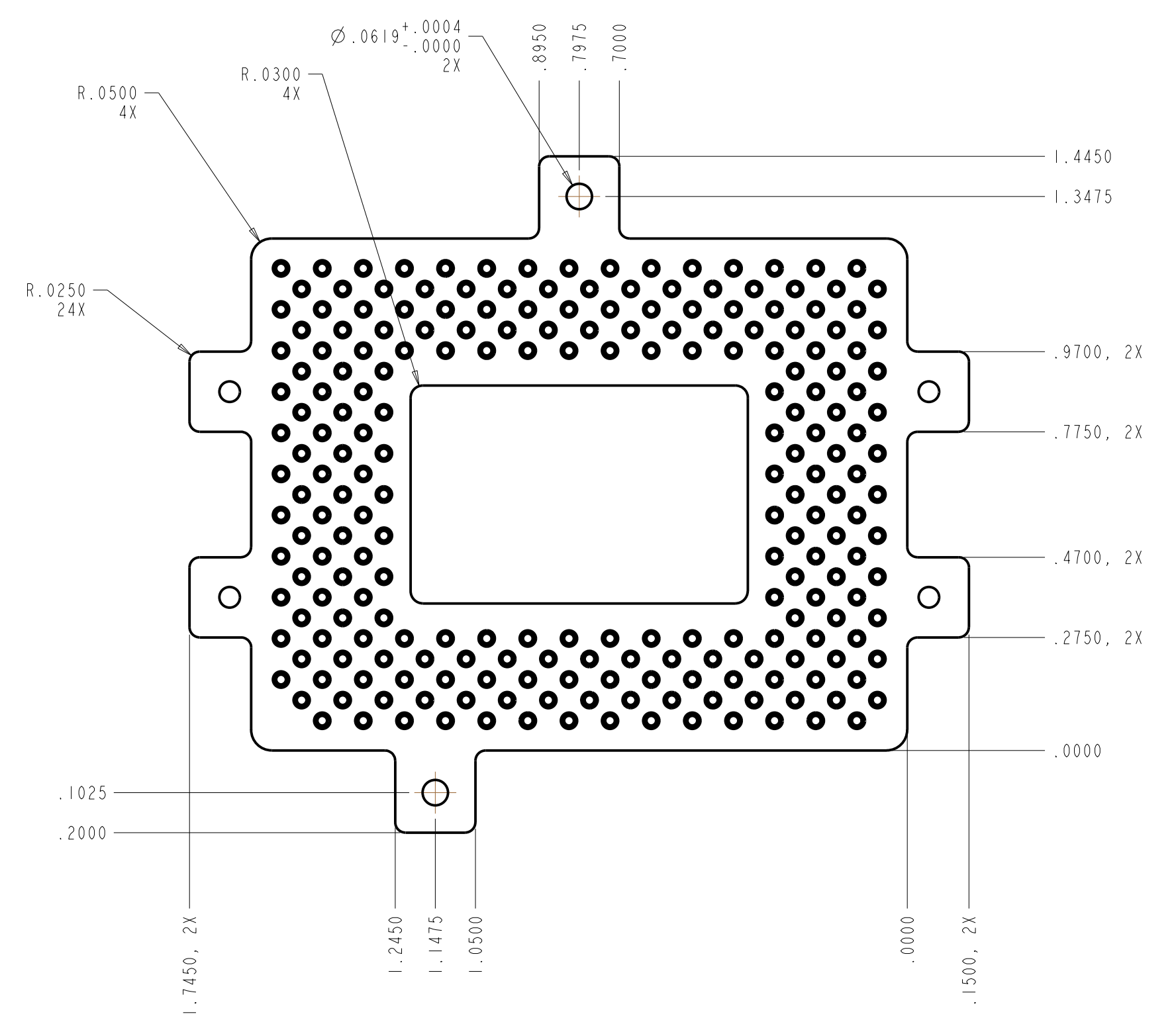
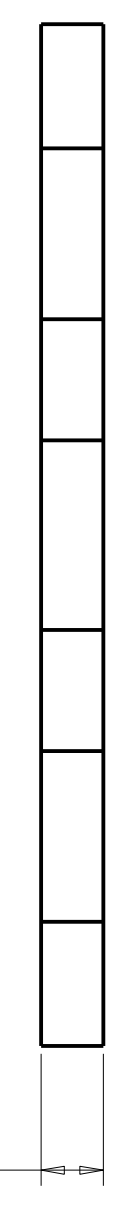
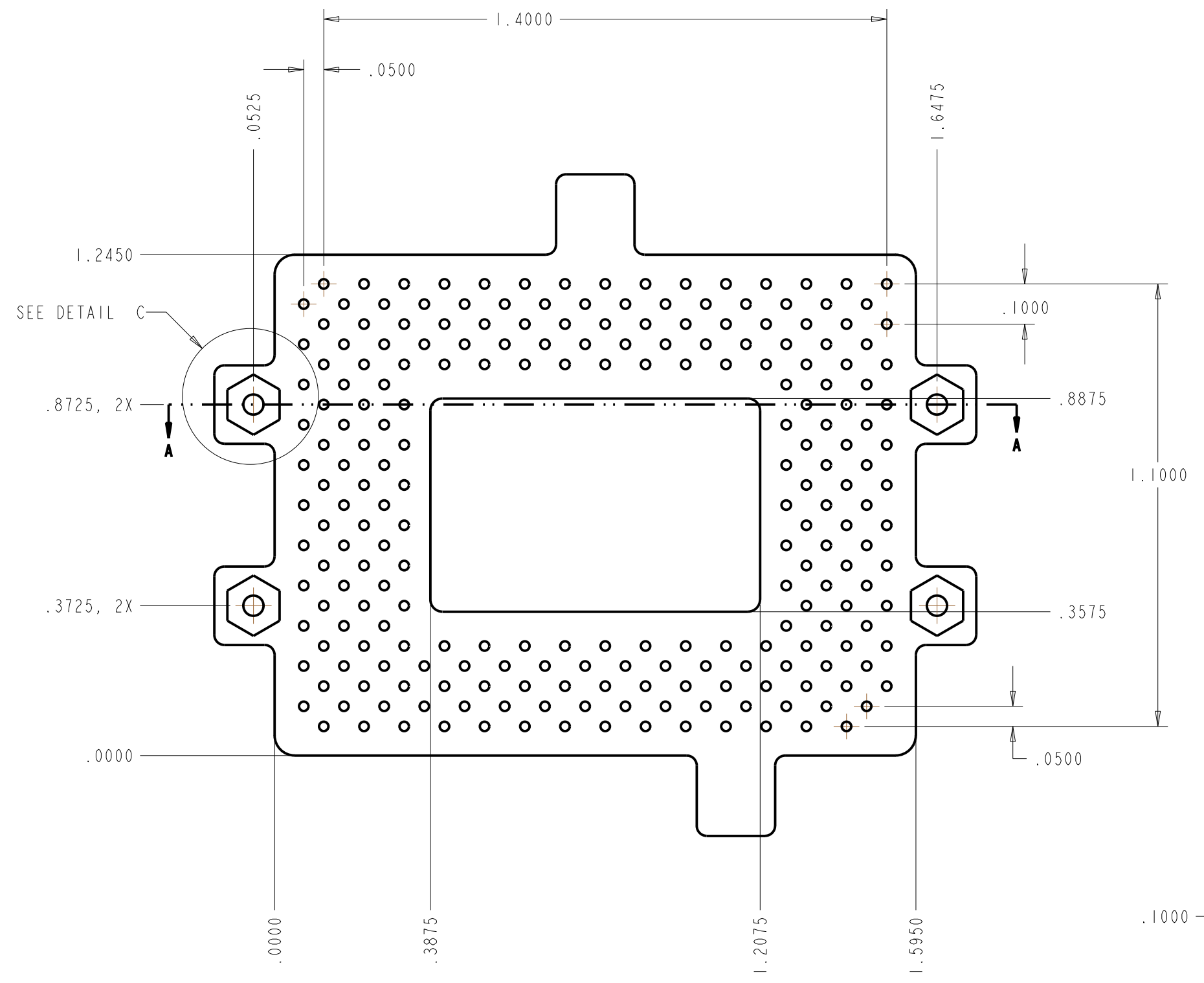
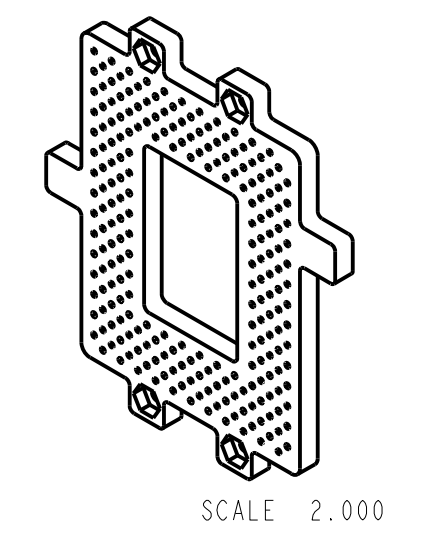
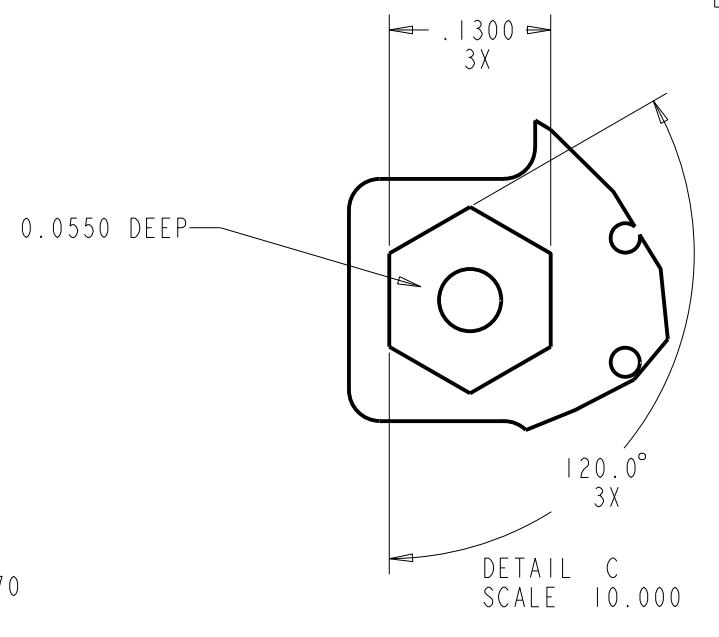
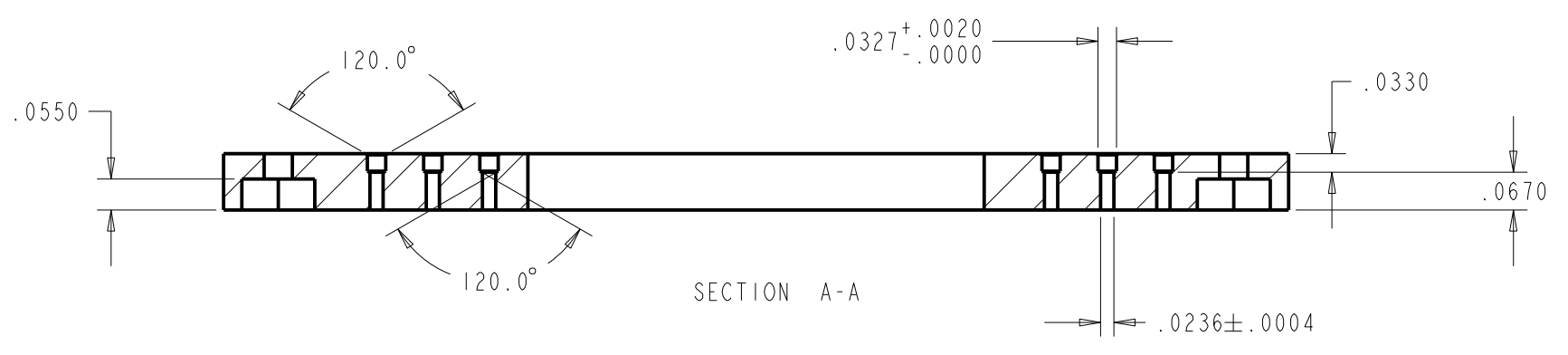

	DWN	DATE	SIZE	DRAWING NO	REV
	A ALJASER	23-Sep-11	D	2511989	B
	ISSUE DATE		SCALE 1.500	SHEET 3 OF 7	

1. MACHINE RADII .062 MAX. UNLESS OTHERWISE STATED.
2. PART MUST BE COMPLETELY FREE OF MACHINING LUBRICANTS INCLUDING TAPPED HOLES.
3. DEBURR ALL EDGES.
4. MATERIAL: TORLON
5. TOLERANCES: .XXXX= ± .0010 OR AS NOTED.

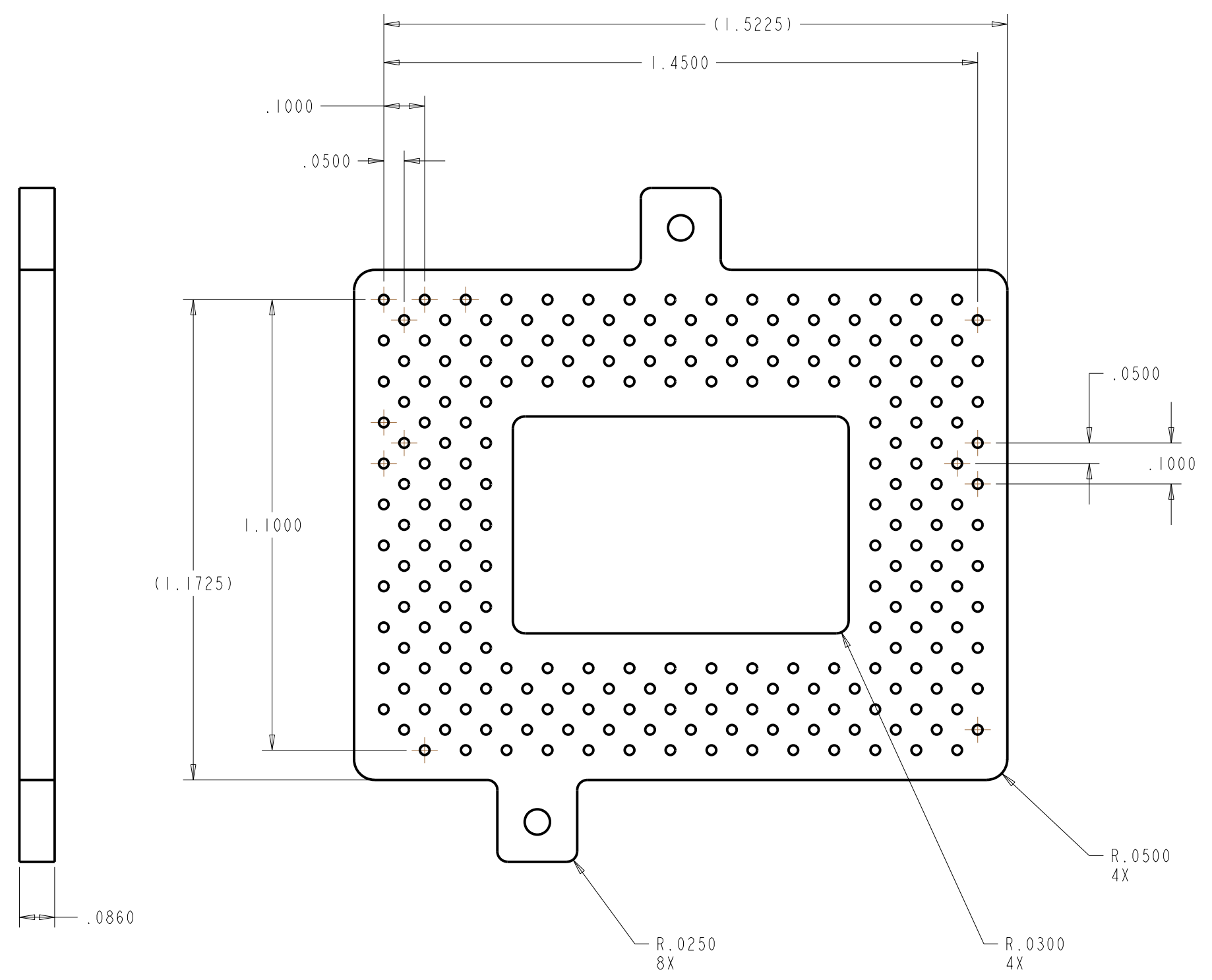
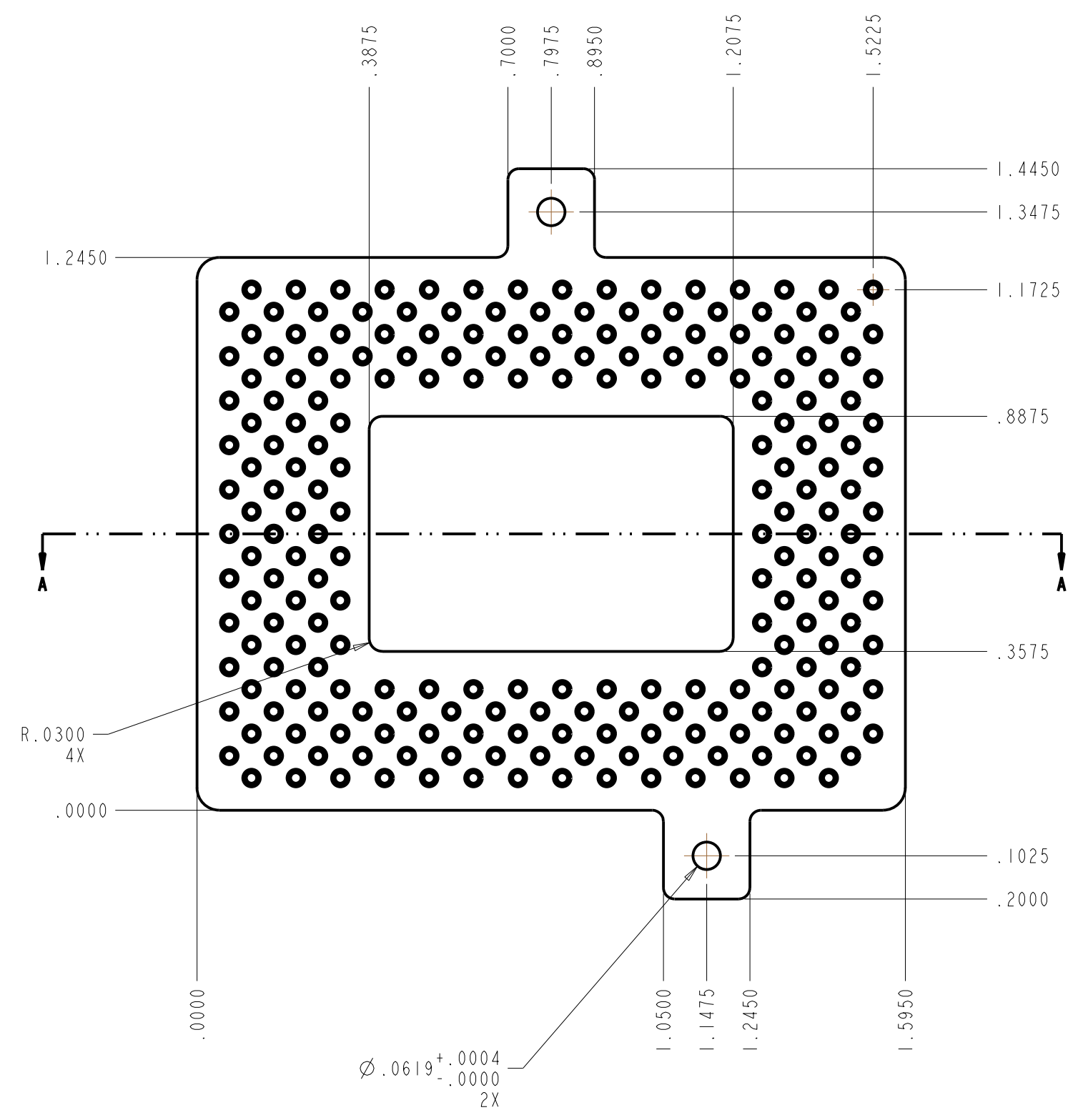
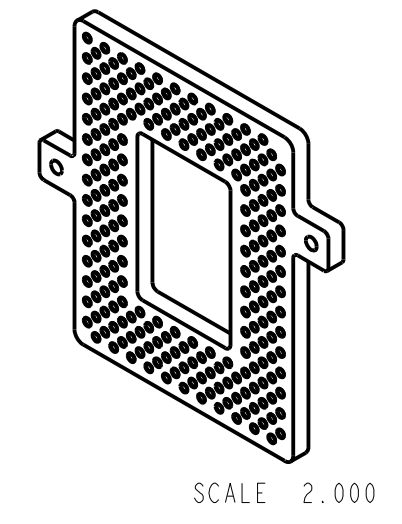
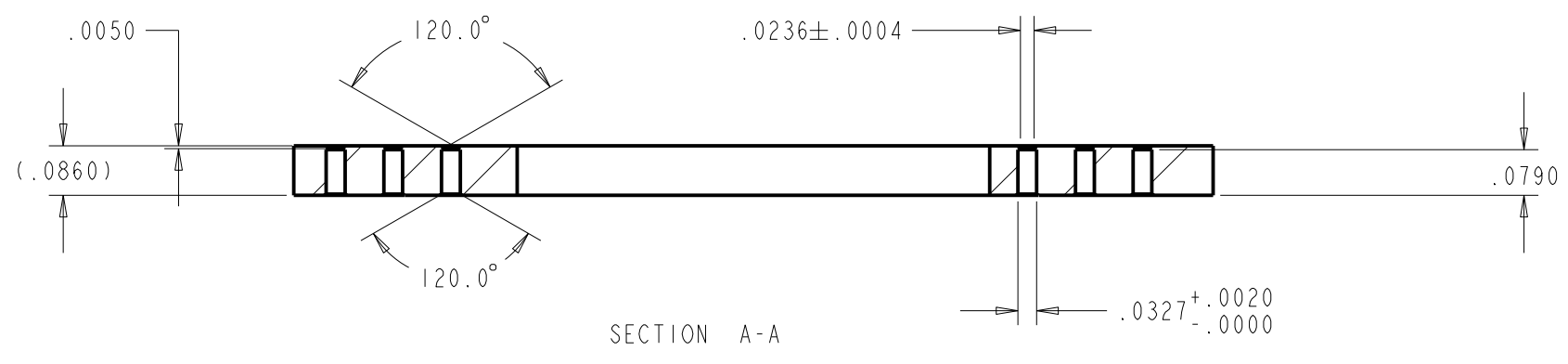

1. MATERIAL: STAINLESS STEEL 303 OR EQUIVALENT  
2. REMOVE ALL SHARP EDGES BEFORE FINISH OPERATION.

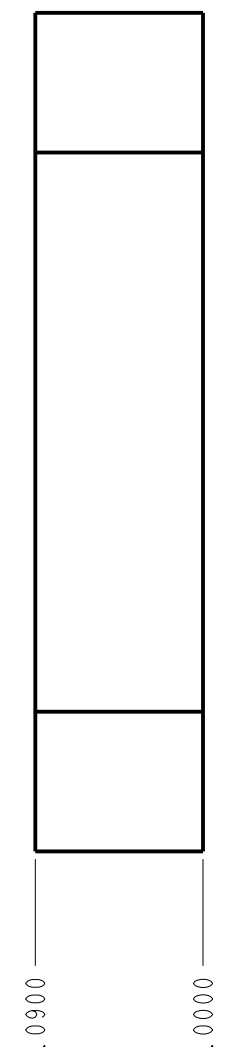
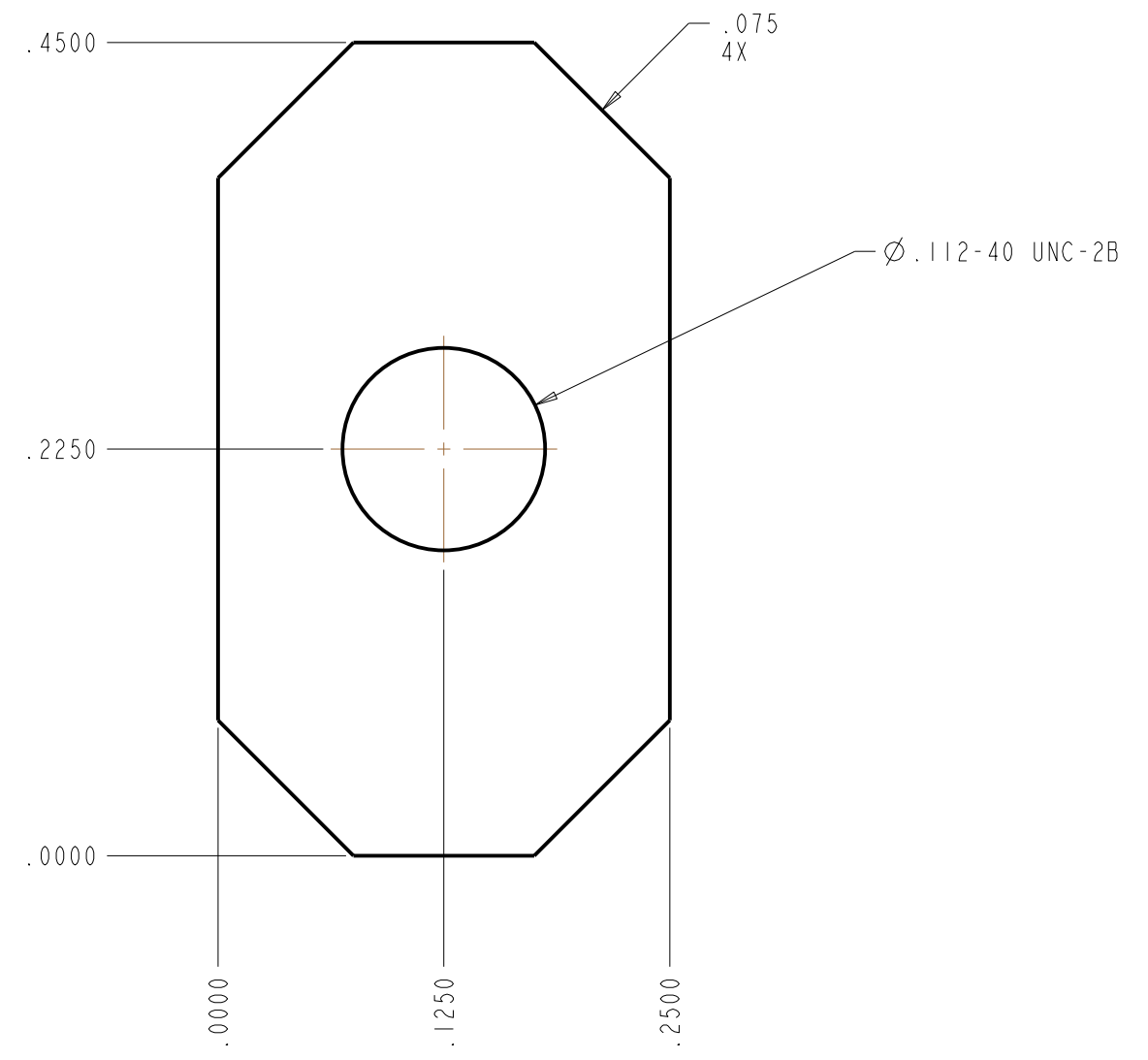
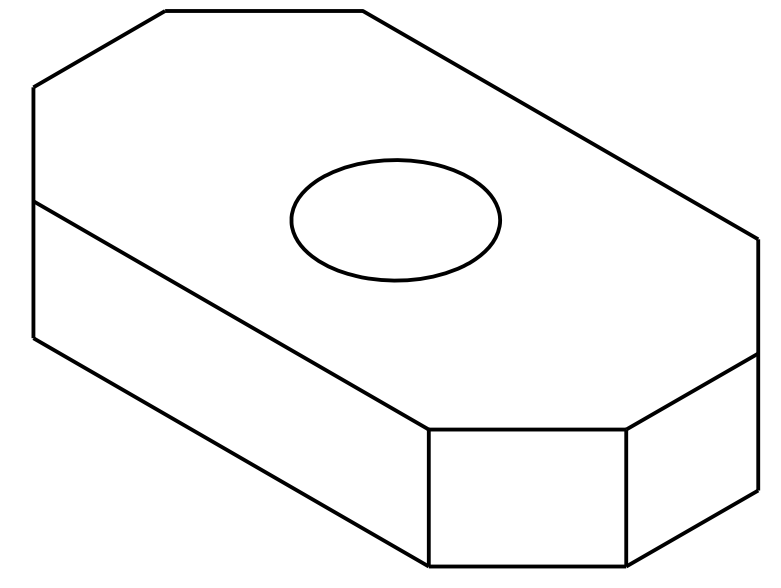

1. PART IS TO BE CLEAN AND FREE OF BURRS.
2. REMOVE ALL SHARP EDGES.
3. MATERIAL: ALUMINUM 6061 OR EQUIV.
4. FINISH: BLACK ANODIZED.

5 MARK PART "2511987" AT APPROXIMATE LOCATION

6 INSTALL DOWEL PIN  $\varnothing 1/8 \times 3/8$ " LONG (McMASTER P/N 90145A470) WITH 0.2750" PROTRUDING

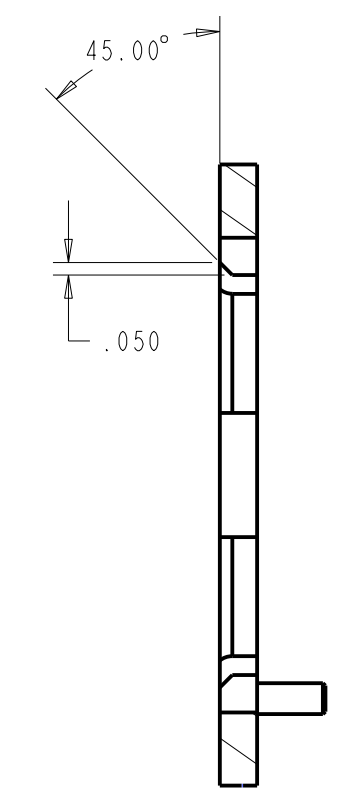
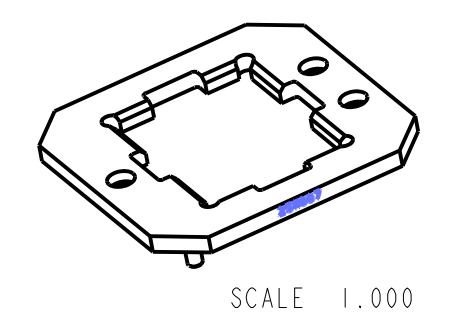
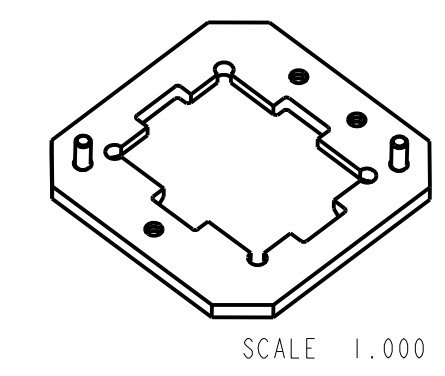

SECTION A-A

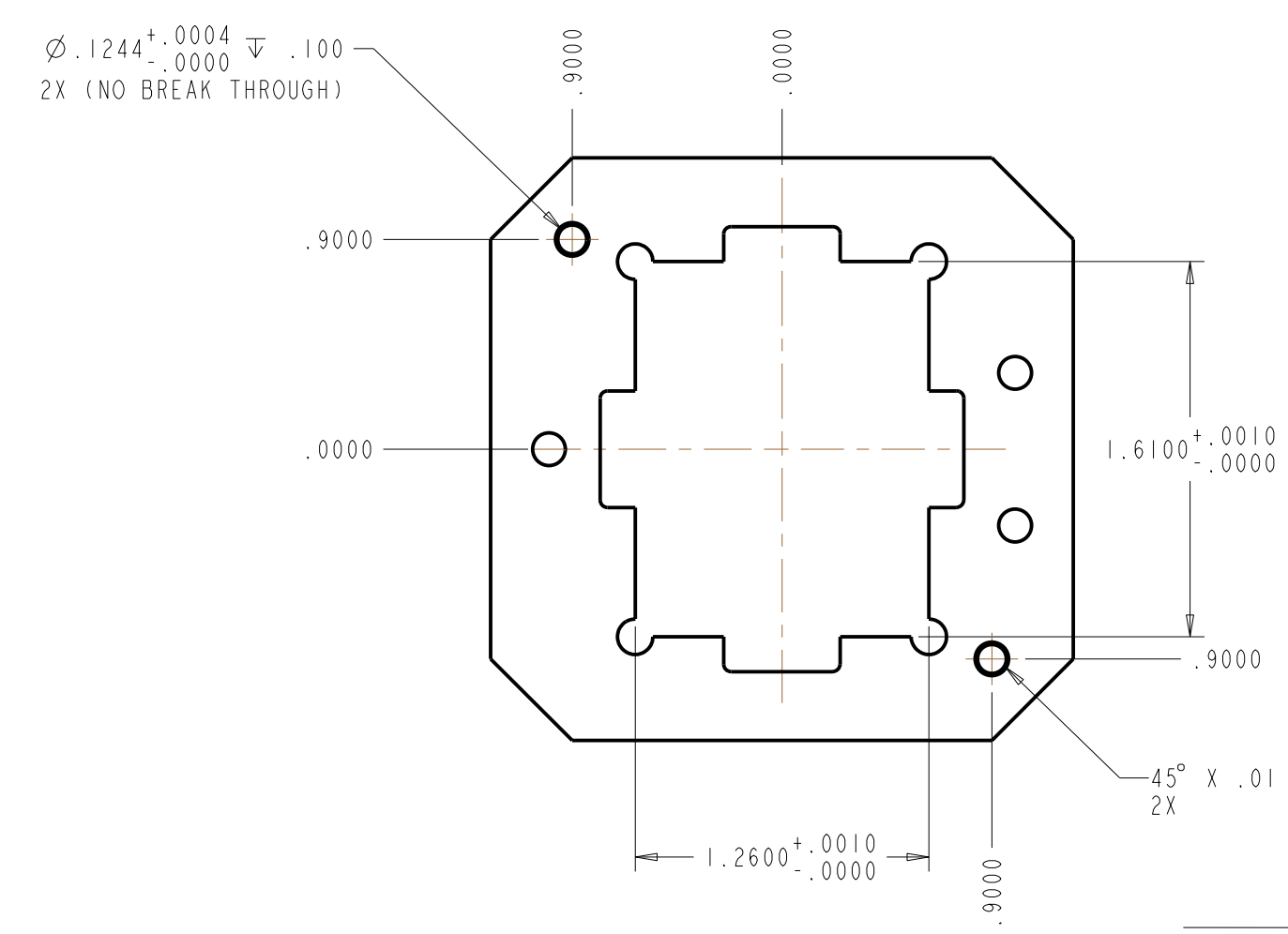
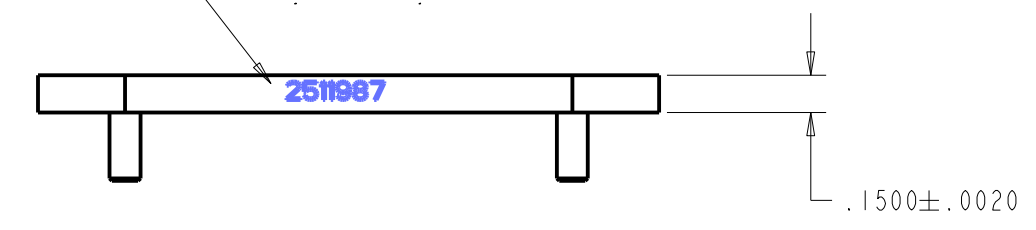
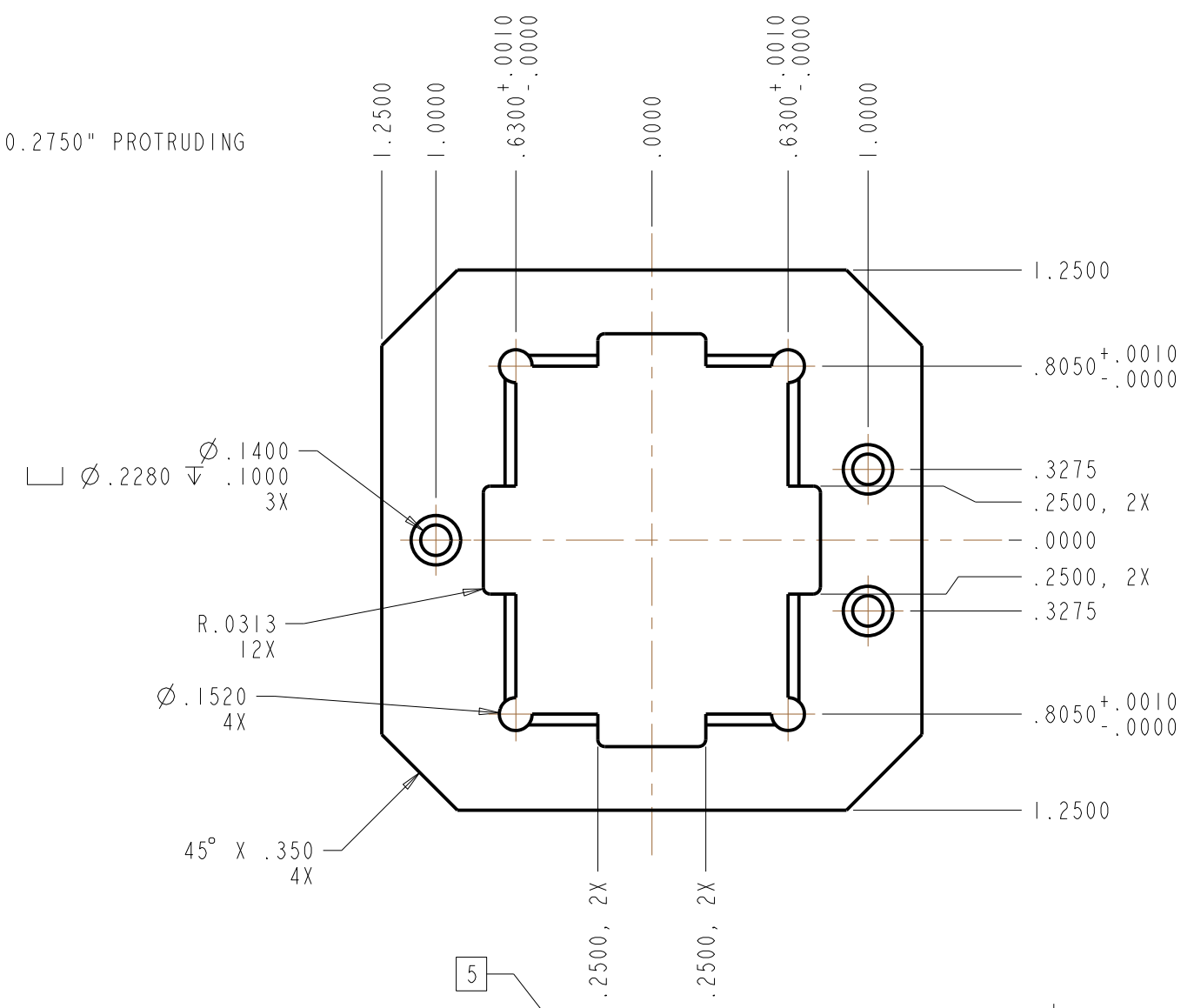
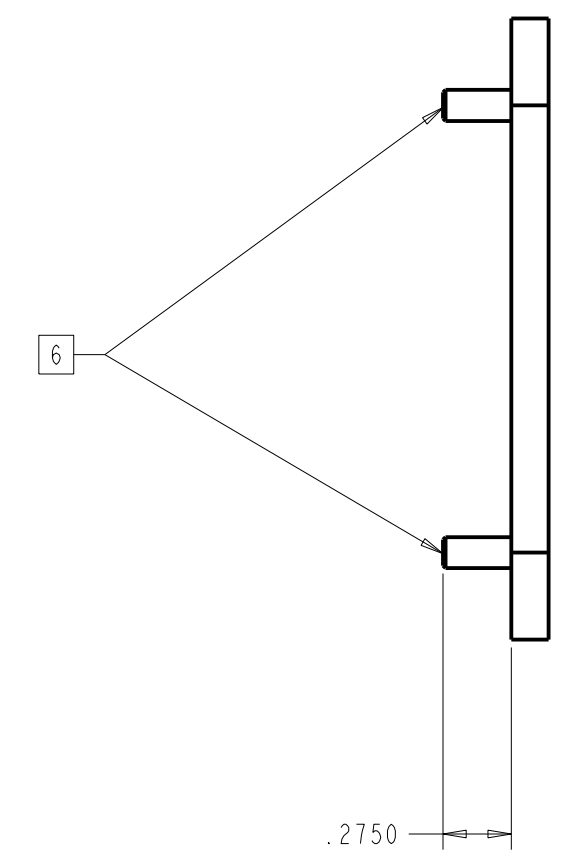

TEXAS INSTRUMENTS DALLAS, TEXAS	DWN A ALJASER	DATE 23-Sep-11	SIZE D	DRAWING NO 2511989	REV B
	ISSUE DATE		SCALE 1.500	SHEET 6 OF 7	



8

7

6

5

4

3

DWG NO 2511989

SH 7

1

© COPYRIGHT 2005 TEXAS INSTRUMENTS  
ALL RIGHTS RESERVED

D

D

C

C

B

B

A

A

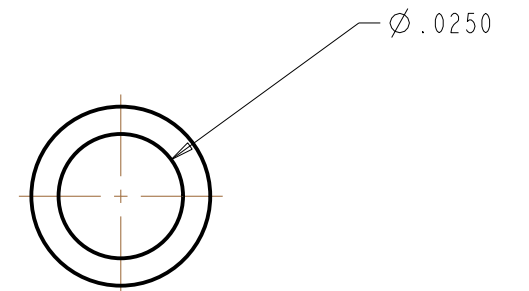
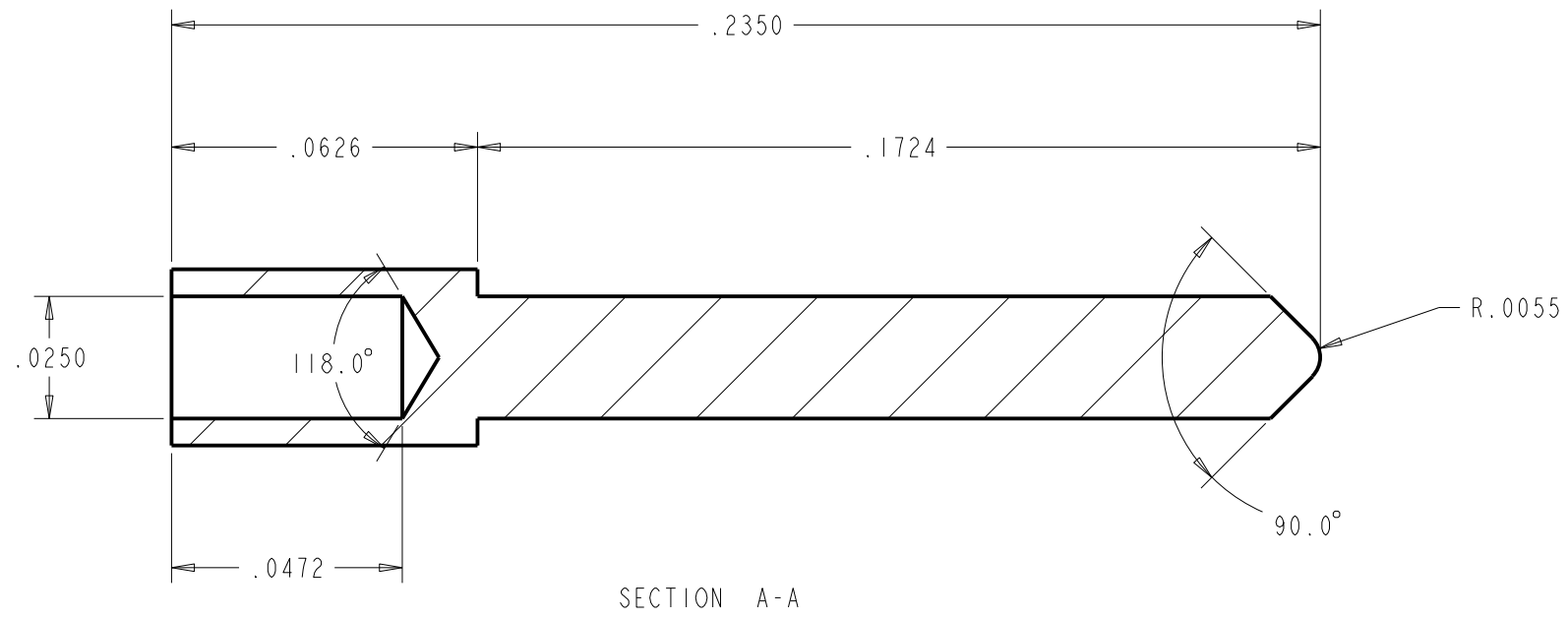
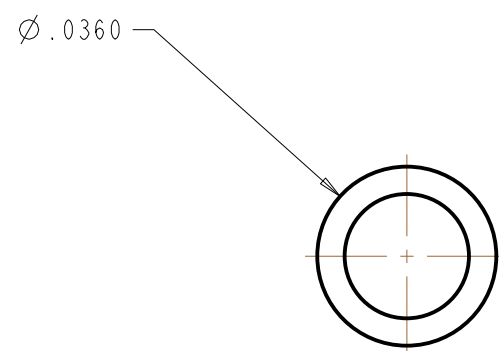
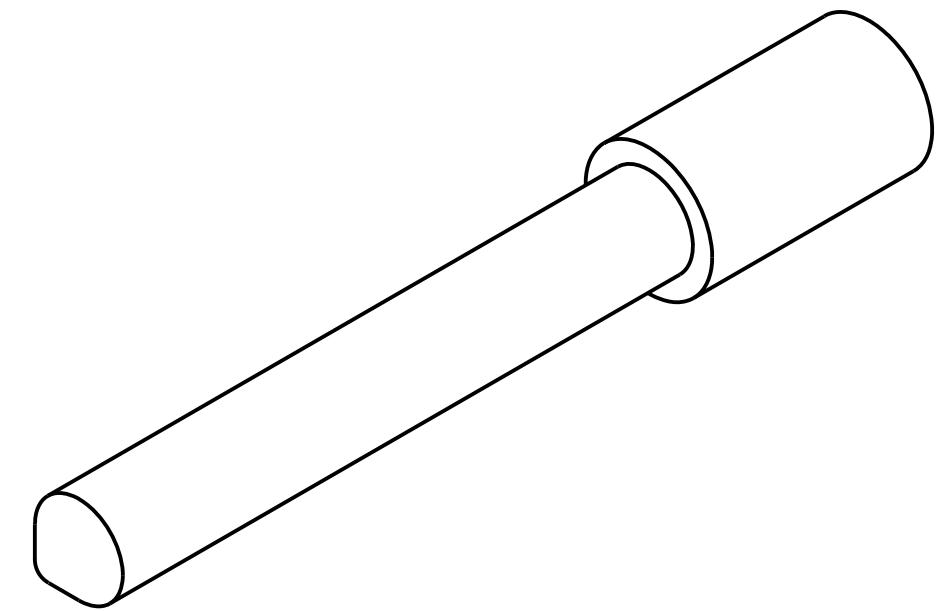

FOR REFERENCE ONLY TO SHOW REQUIREMENTS  
 CONTECH SOLUTIONS INC CONTROLS EXTENDER DESIGN

TEXAS INSTRUMENTS <small>DALLAS, TEXAS</small>	DWN	DATE	SIZE	DRAWING NO	REV
	A ALJASER	23-Sep-11	D	2511989	B
	ISSUE DATE		SCALE 1.500	SHEET 7 OF 7	

Pro/E-asm-11-D

8

7

6

5

4

3

2

1